

Sanicubic 2 GR

Grey water, black water

The Sanicubic 2 GR is a heavy duty grinder lifting station designed for villas, pool-houses etc. This station is equipped with 2 pumps with the Pro X K3 dilaceration system, which are activated simultaneously in case of a large supply.

Sanicubic 2 GR is available in 4 versions for 4 high level lifting performances. It has 5 inlets of different diameters.

The station is delivered with a pneumatically controlled remote control box including an audible and visual alarm.



PERFORMANCES

- Total manometric head : 39 m
- Max. flow rate : 17 m³/h

DEPENDING ON MODEL

PRODUCT BENEFITS

- Installation without excavation.
- Accessibility in case of maintenance.
- Expansion wheels.
- 3 inlets DN 100, 2 inlets DN 50.
- 150 litre tank.
- 4 three-phase versions.
- Including non-return valve & outlet flange.

DELIVERED AS STANDARD

ZPS control boxes - two-pump versions



CONNECTIONS

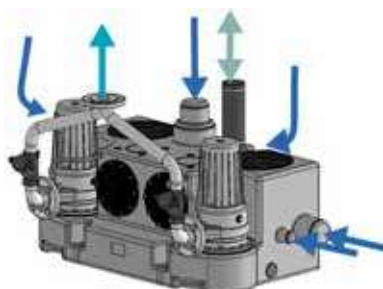

- Inlet diameter DN : 100, 150
- Discharge diameter DN : 50
- Ext. ventilation diameter : 75 mm



Pro X K3 grinder

DIMENSIONS

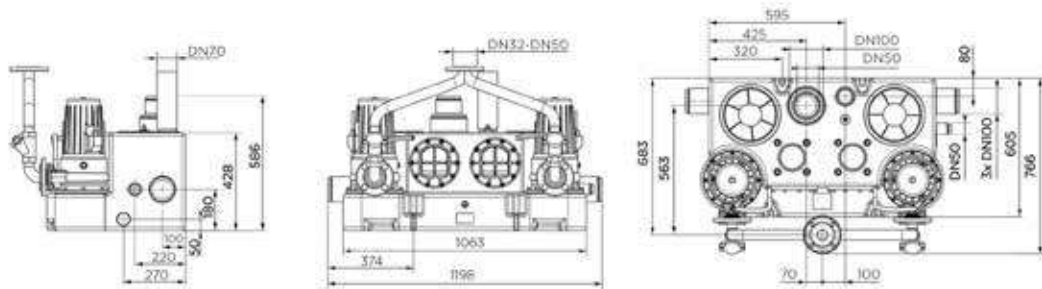

Dimensions (mm)

CURVE

Discharge height (m)

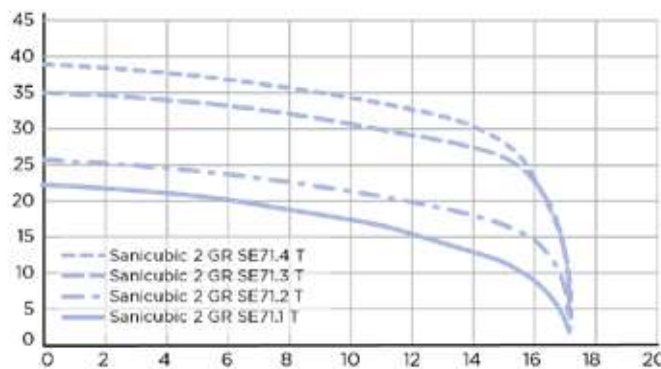

Flow rate (m³/h)

	Sanicubic 2 GR SE71.1 T	Sanicubic 2 GR SE71.2 T	Sanicubic 2 GR SE71.3 T	Sanicubic 2 GR SE71.4 T
Type of control box	ZPS 2 case	ZPS 2 case	ZPS 2 case	ZPS 2 case
Material				
Tank	PE LD	PE LD	PE LD	PE LD
Pump housing	GG-20	GG-20	GG-20	GG-20
Motor housing	GG-20	GG-20	GG-20	GG-20
Impeller	GG-20	GG-20	GG-20	GG-20
Technical features				
Voltage (V)	400	400	400	400
Frequency (Hz)	50-60	50-60	50-60	50-60
Power consumption P1 (W)	2100	2100	3900	3900
Power output P2 (W)	1700	1700	3200	3200
Mode of operation	S3 25%	S3 25%	S3 25%	S3 25%
IP Rating	IP68	IP68	IP68	IP68
Hydraulics				
Total manometric head (m)	22	25	35	39
Max. flow rate (m ³ /h)	17	17	17	17
Inlet diameter DN	100, 150	100, 150	100, 150	100, 150
Discharge diameter DN	50	50	50	50
Ext. ventilation diameter (mm)	75	75	75	75
Total volume (L)	150	150	150	150
ON Level /OFF level (mm)	140-250/30	140-250/30	140-250/30	140-250/30
Alarm level (mm)	180-290	180-290	180-290	180-290
Max. temperature of the pumped liquid (5 min)	55 °C	55 °C	55 °C	55 °C
Type of impeller	Pro X K3 grinder	Pro X K3 grinder	Pro X K3 grinder	Pro X K3 grinder
Type of activation	Pneumatic	Pneumatic	Pneumatic	Pneumatic
Identification and logistics				
Gross weight (kg)	137	137	144	144
Factory code	CUBIC2GRSE71-1T	CUBIC2GRSE71-2T	CUBIC2GRSE71-3T	CUBIC2GRSE71-4T